



EVOTECH®
P E R F O R M A N C E

Ducati Supersport
Crash Protection

Installation Instructions



Product No: PRN013743

Kit Contents

- | | |
|---|--|
| A 1 x RH Arm | J 2 x Bobbin Heads |
| B 1 x RH Front Frame Spacer (25mm) | K 2 x Bobbin Spacers |
| C 1 x RH Rear Frame Spacer (59mm) | L 2 x M12 Washers |
| D 1 x LH Arm | M 2 x Impact Absorbing Washers |
| E 1 x LH Front Frame Spacer (60mm) | N 3 x M12 - 130 x 1.25 Cap Head Bolts |
| F 1 x LH Rear Frame Spacer (52mm) | O 3 x Top Hat Washer |
| G 1 x M12 - 85 x 1.25 Cap Head Bolt | P 3 x Grommets |
| H 1 x M12 - 90 x 1.25 Cap Head Bolt | Q 3 x M5 x 16 Black Button Head |
| I 1 x M12 - 100 x 1.25 Cap Head Bolt | |



Frame spacer identification and placement is critical to the installation process

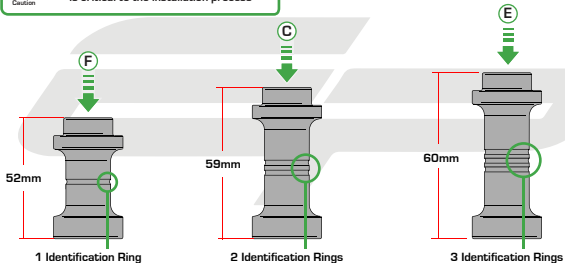



Left Hand Side

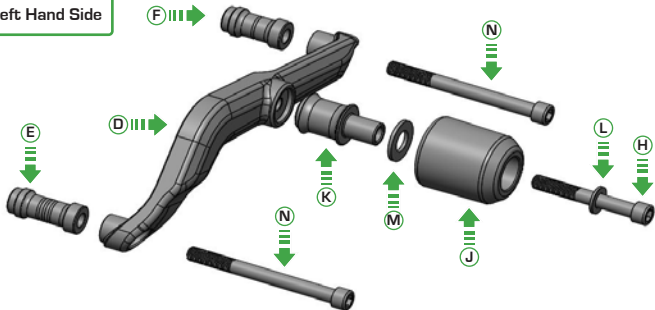

Right Hand Side

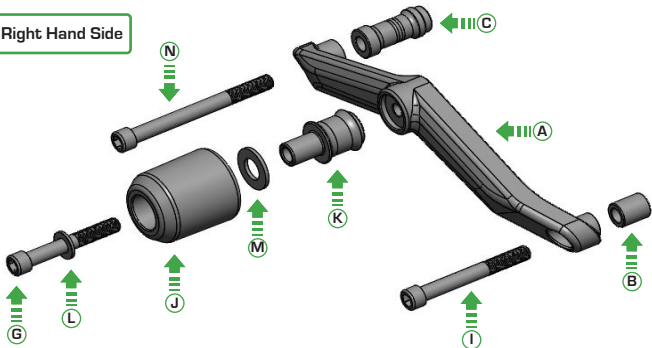

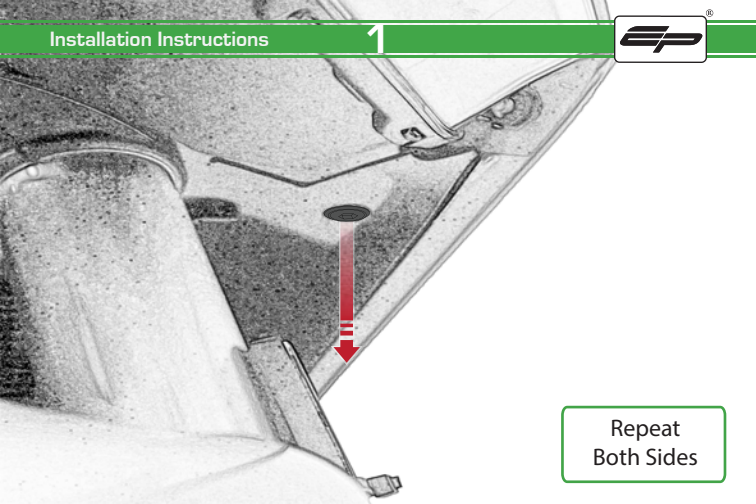

Repeat
Both Sides

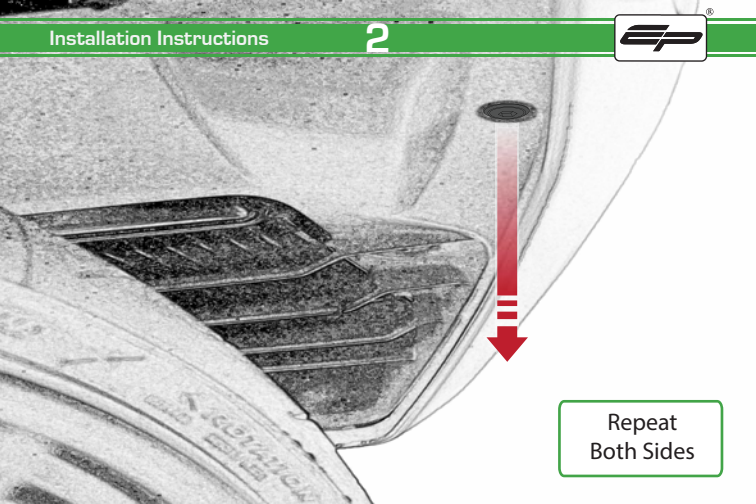

Repeat
Both Sides

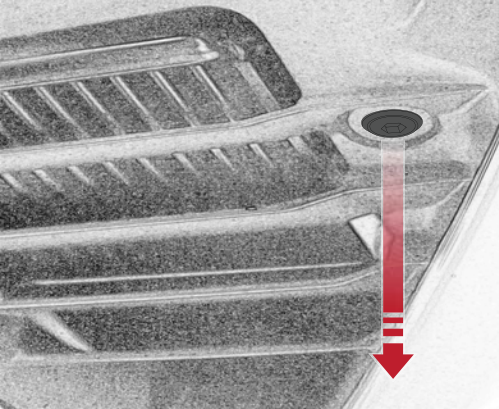

Repeat
Both Sides

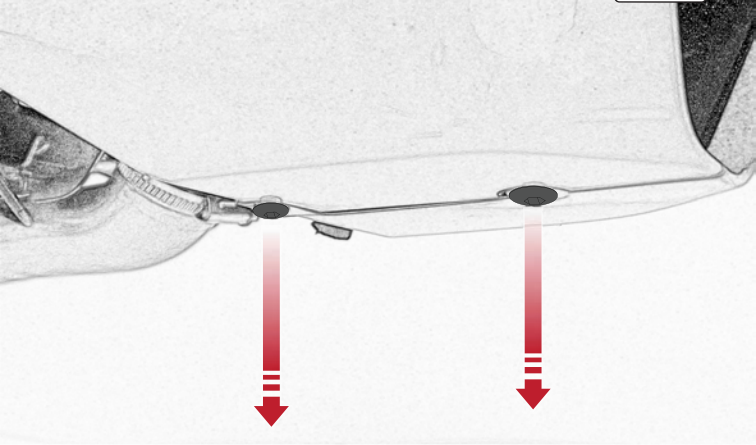

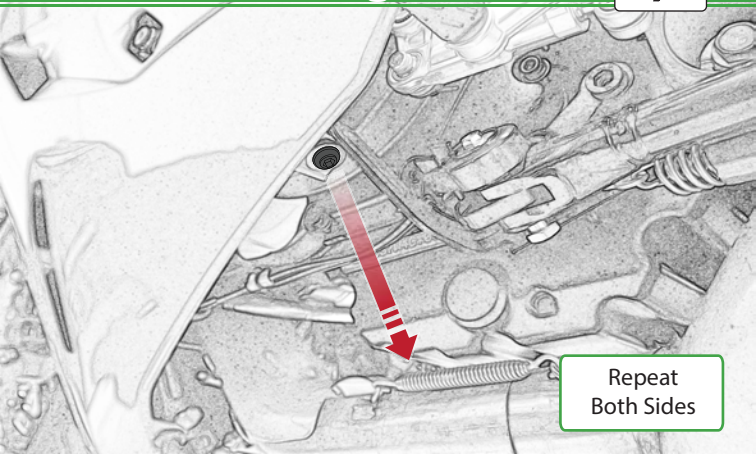

Repeat
Both Sides

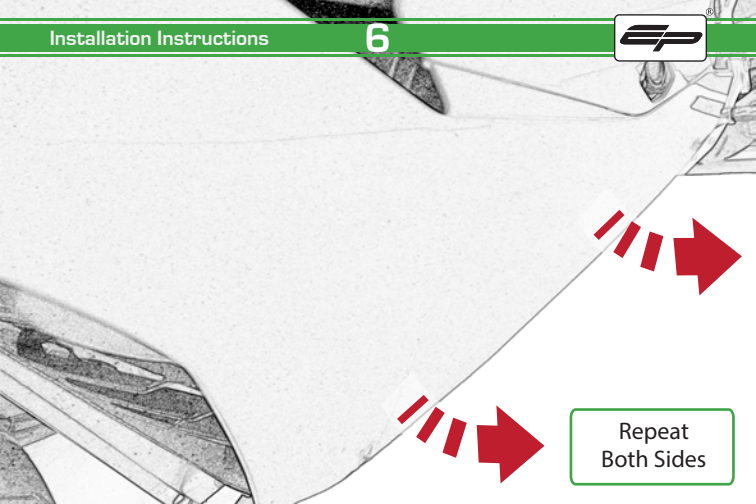

Repeat
Both Sides

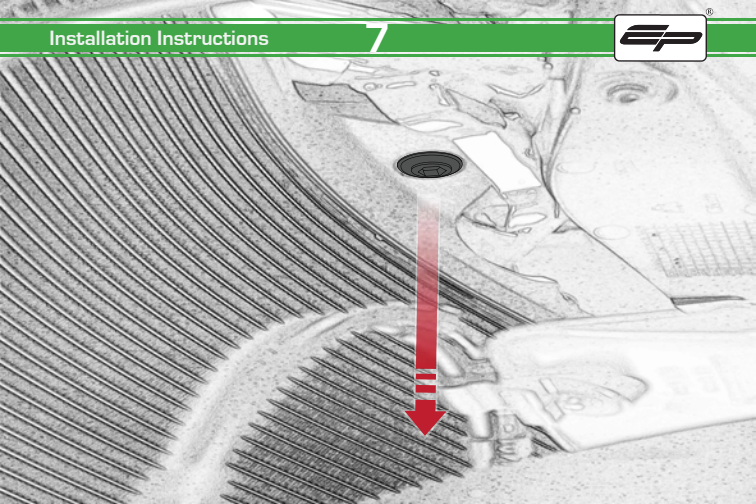



Repeat
Both Sides

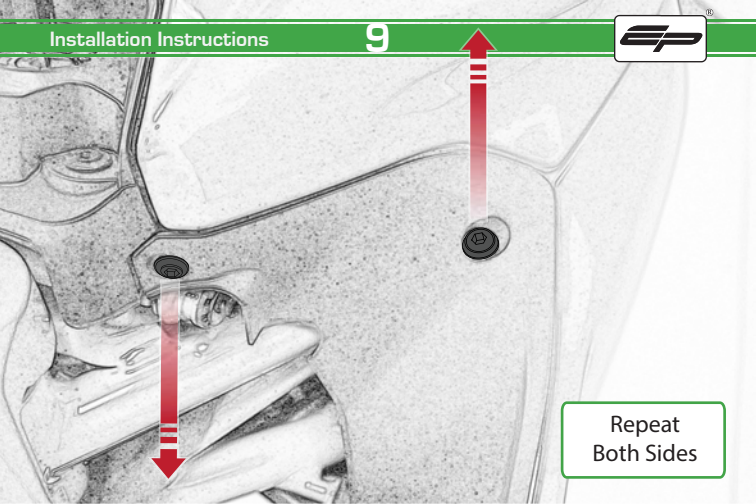

Repeat
Both Sides



Repeat
Both Sides



Repeat
Both Sides



Repeat
Both Sides

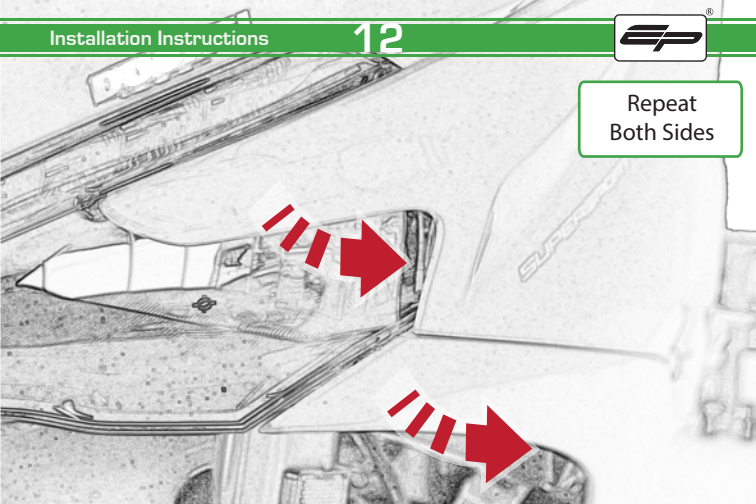



Repeat
Both Sides

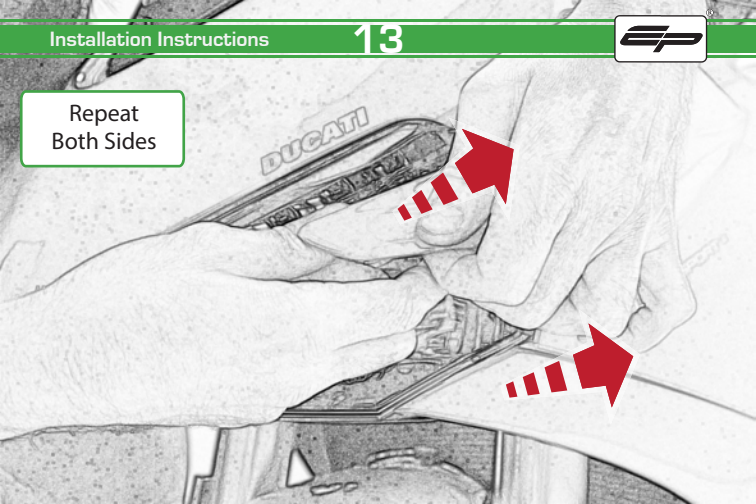



Repeat
Both Sides

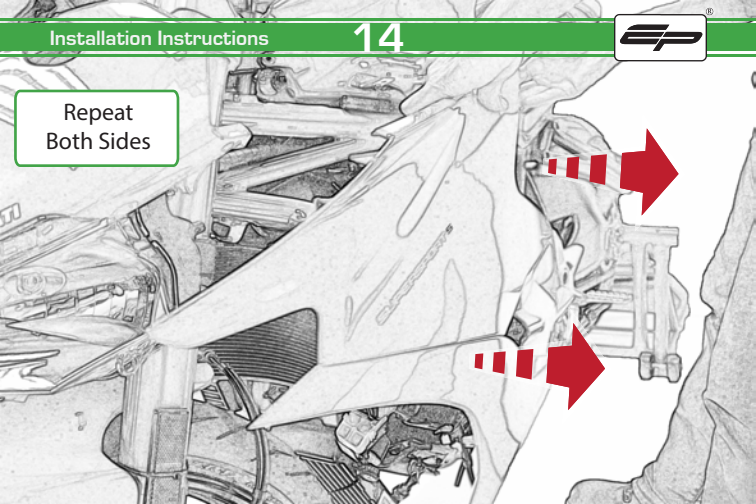



Repeat
Both Sides

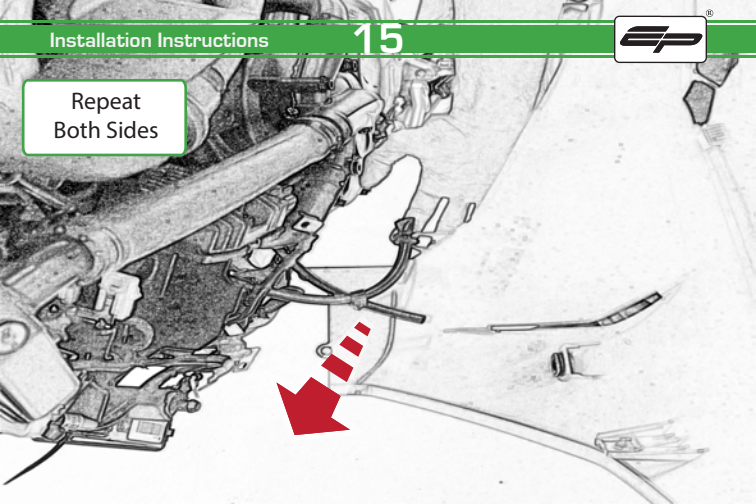

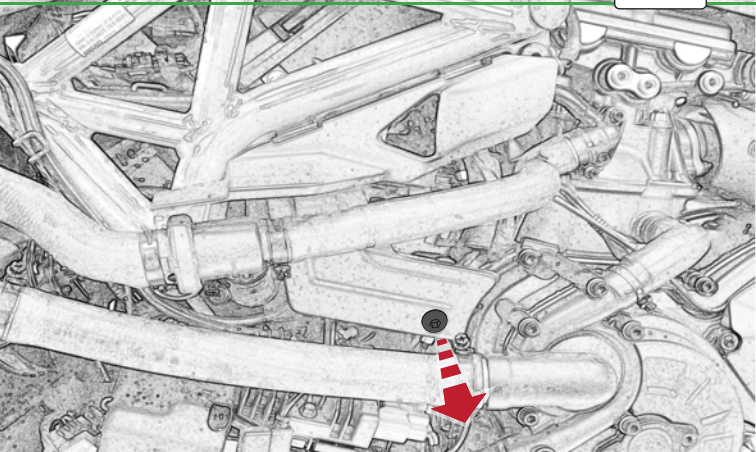

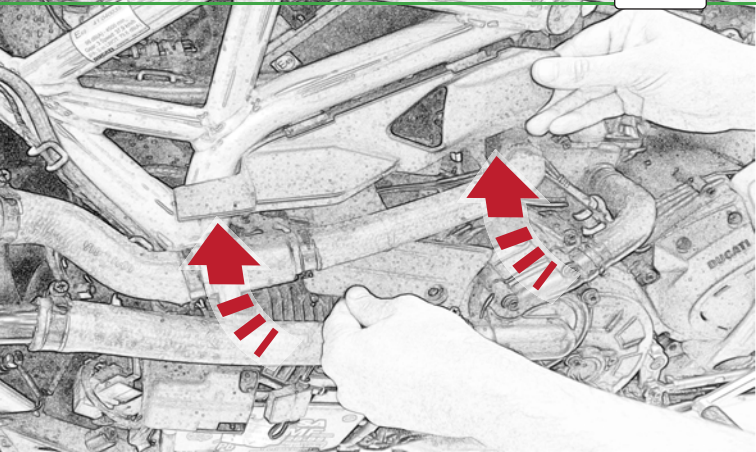

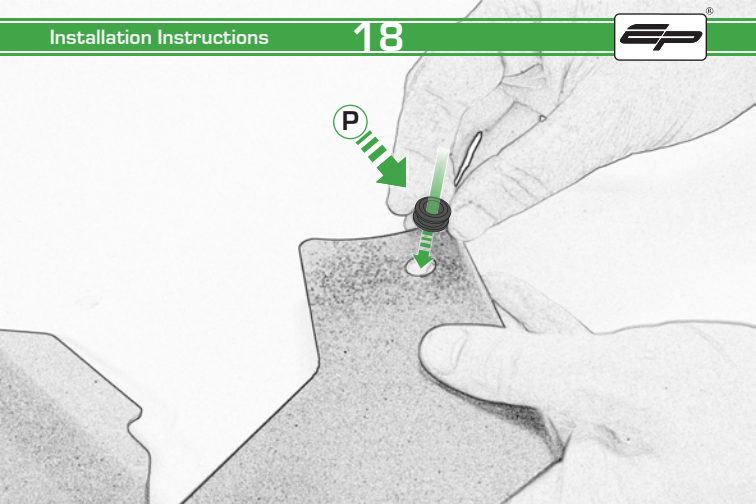

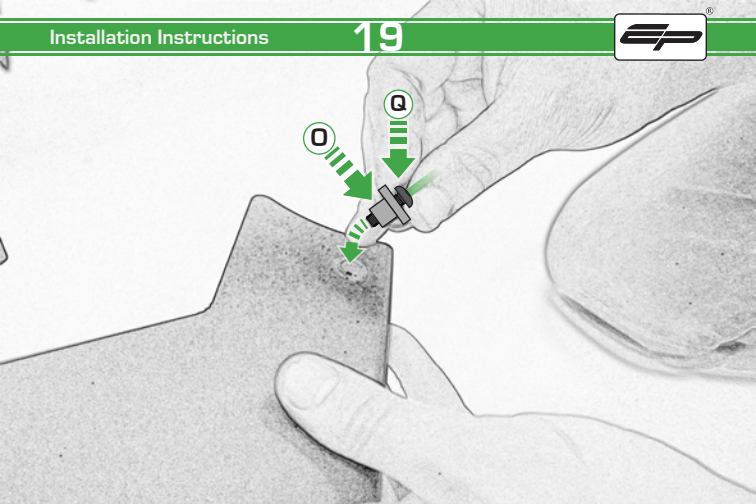

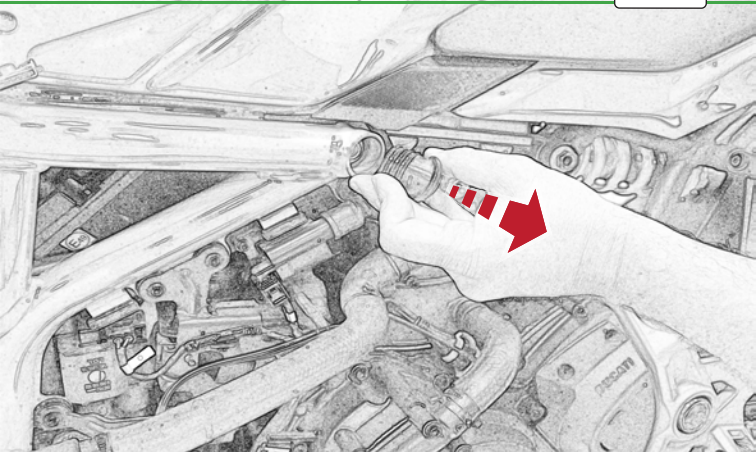

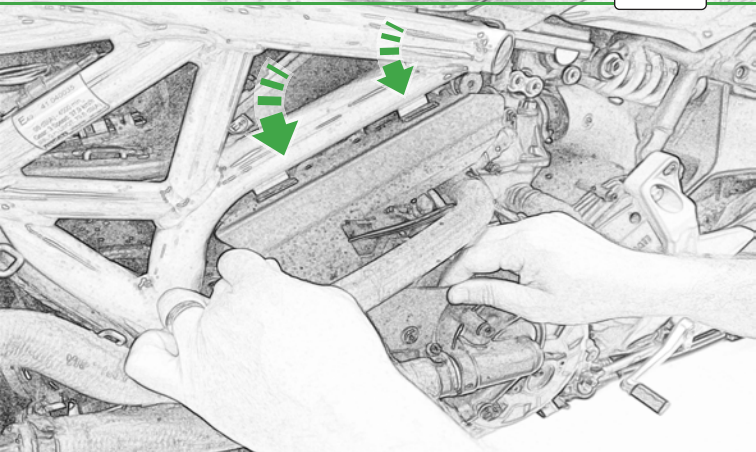

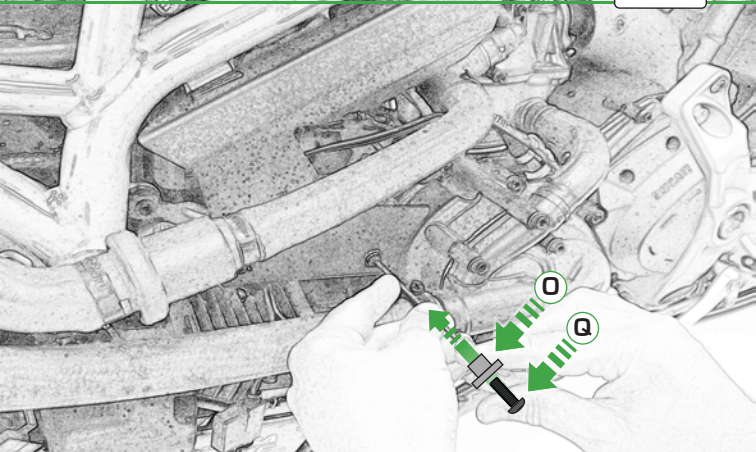

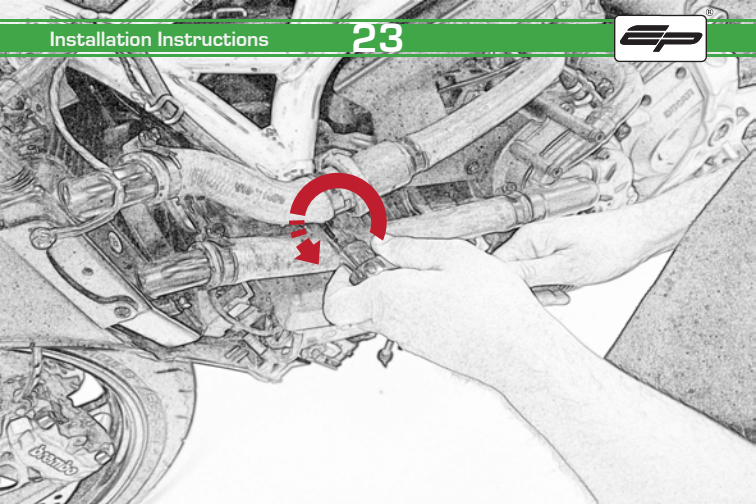

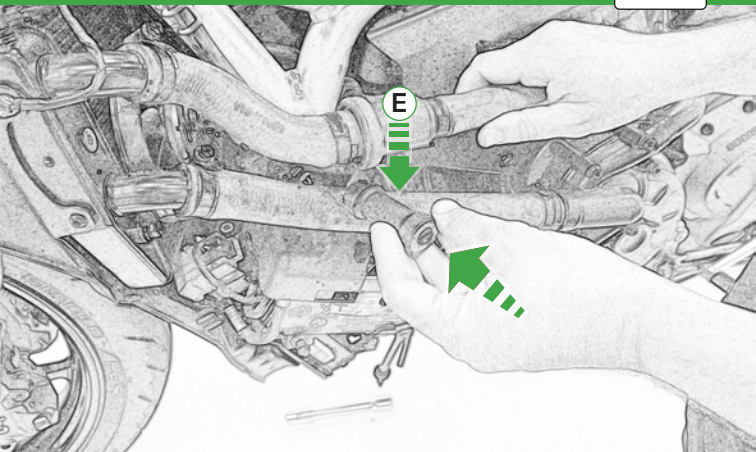





Caution

**Do Not Fully Tighten
20 Rotations Only**

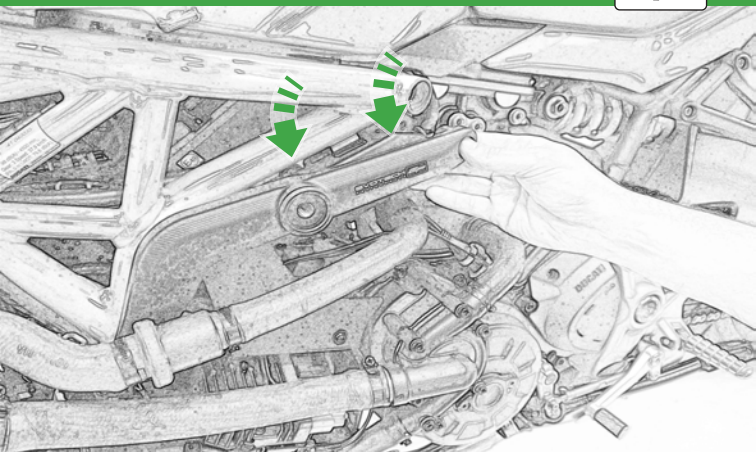

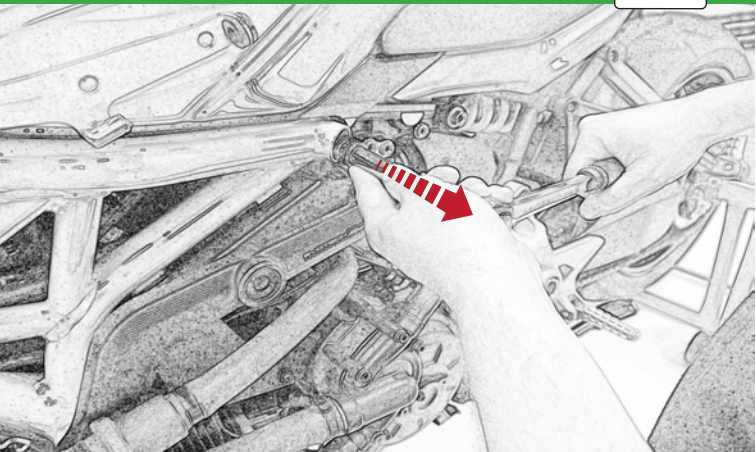

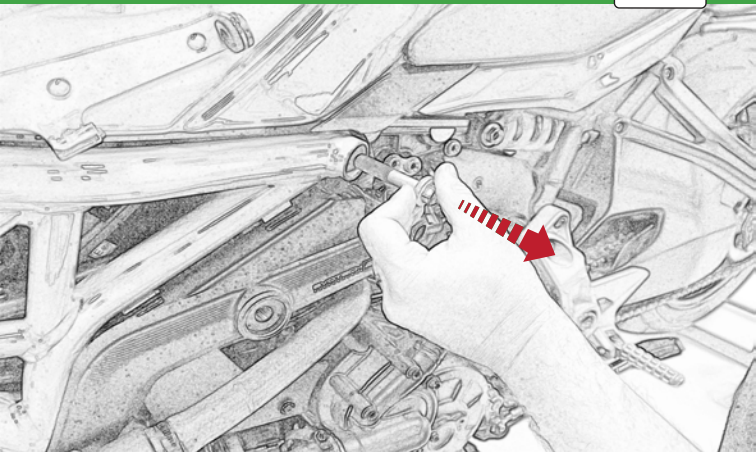

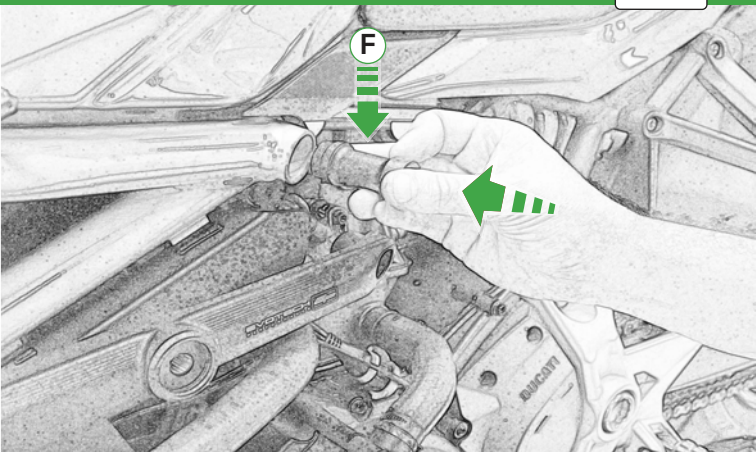

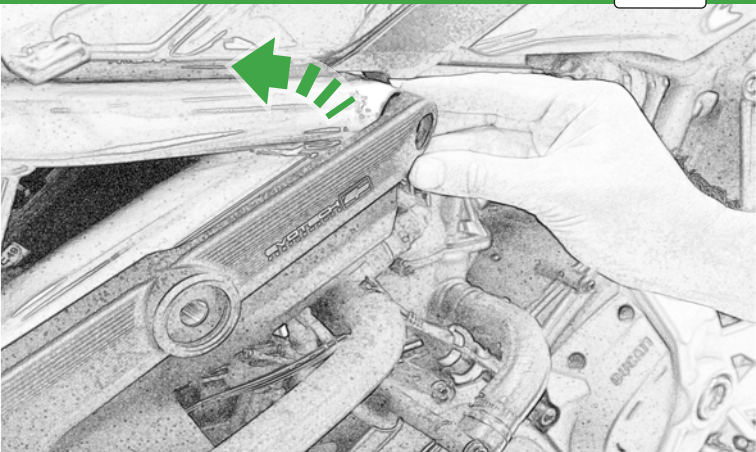

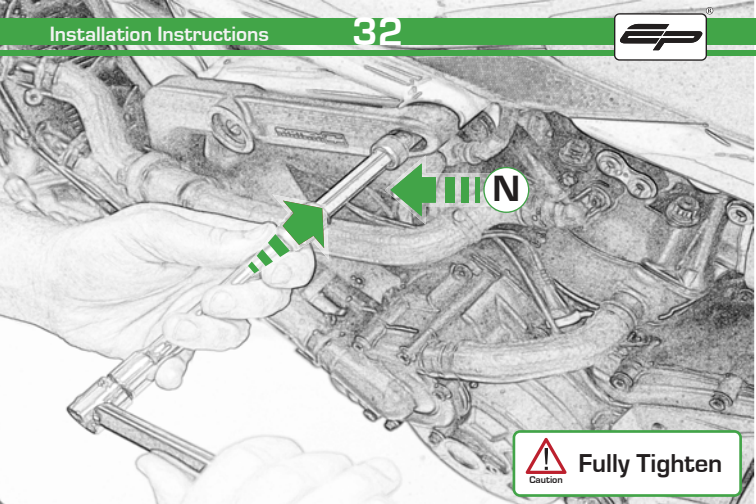

N



Caution

Fully Tighten

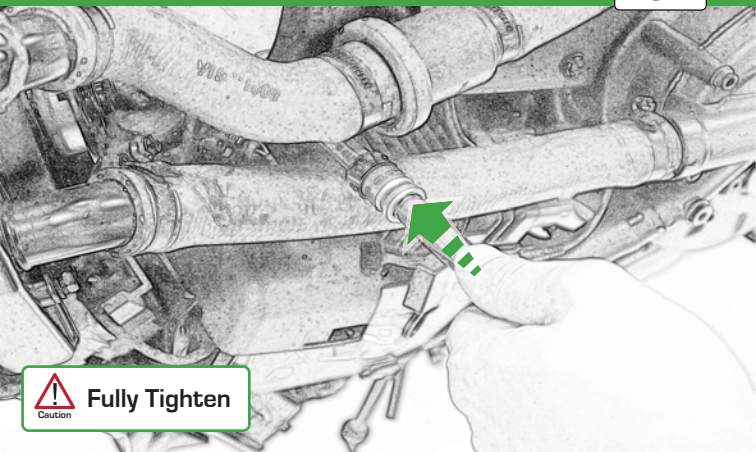

Caution

Fully Tighten

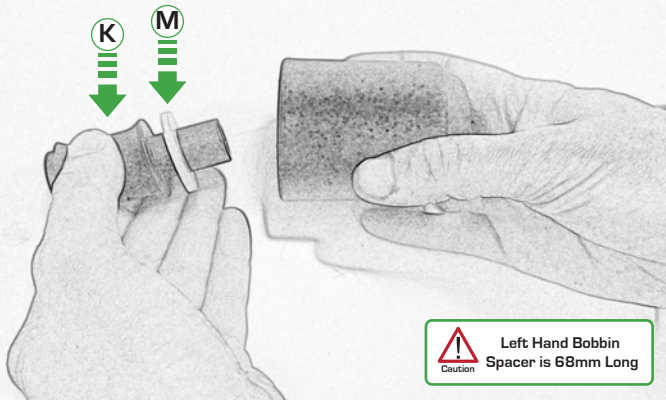

**Left Hand Bobbin
Spacer is 68mm Long**



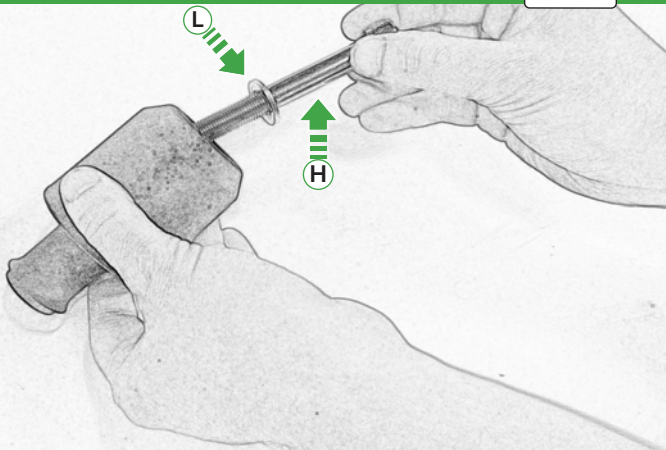

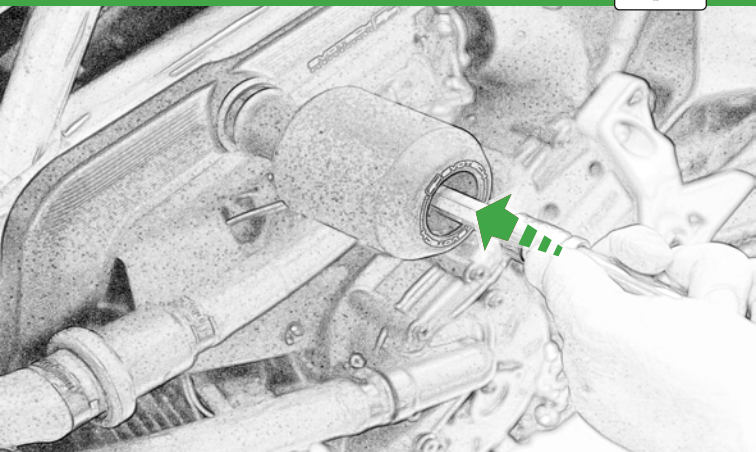

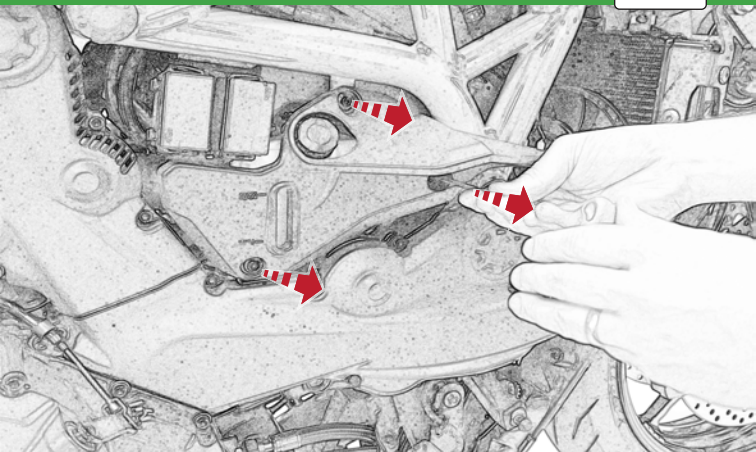

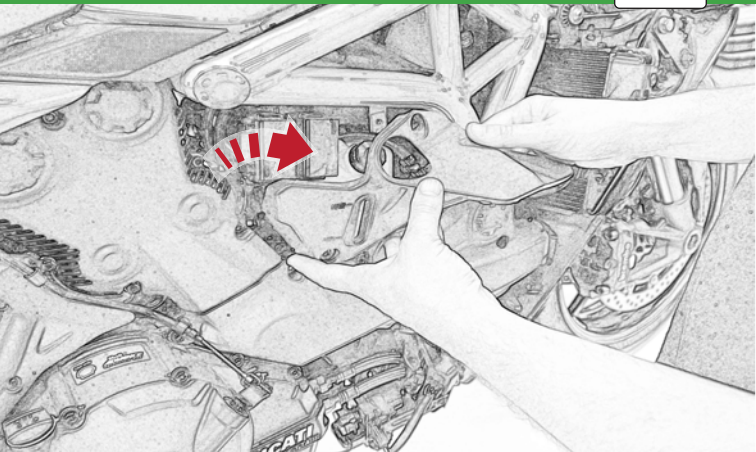

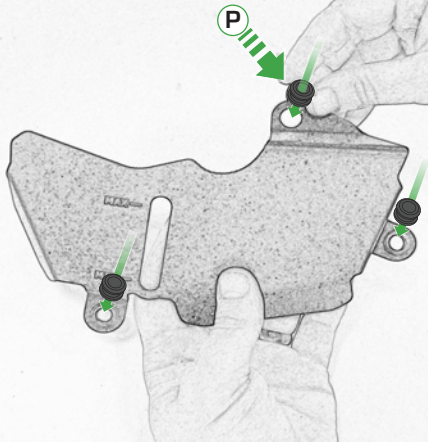

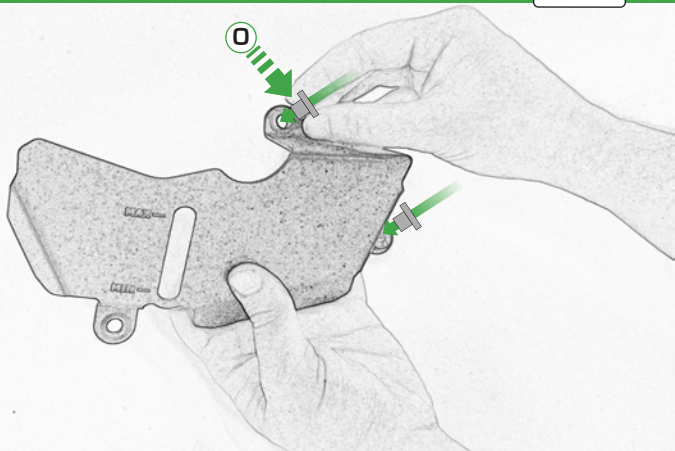

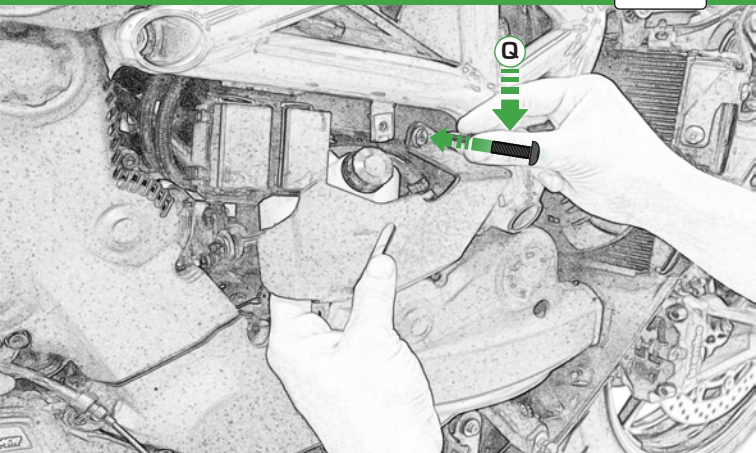

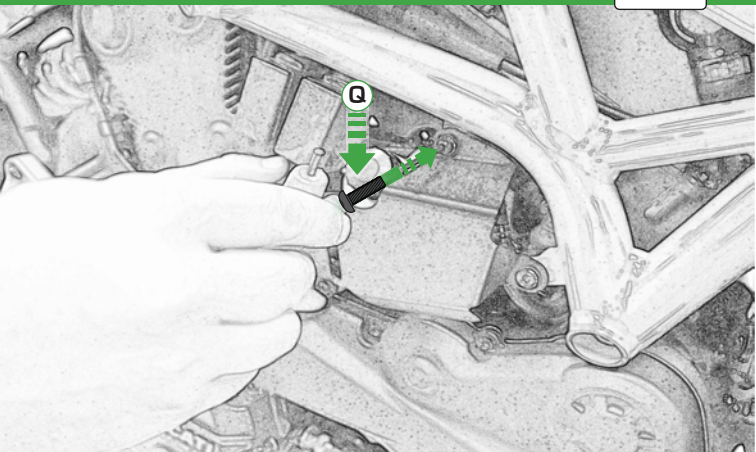

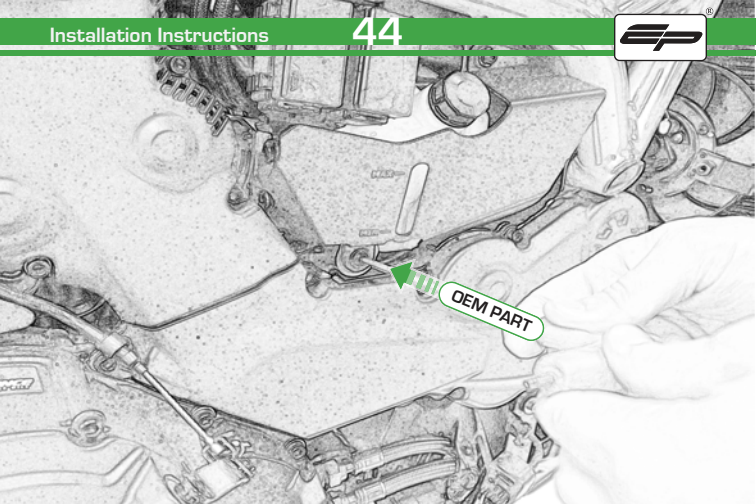

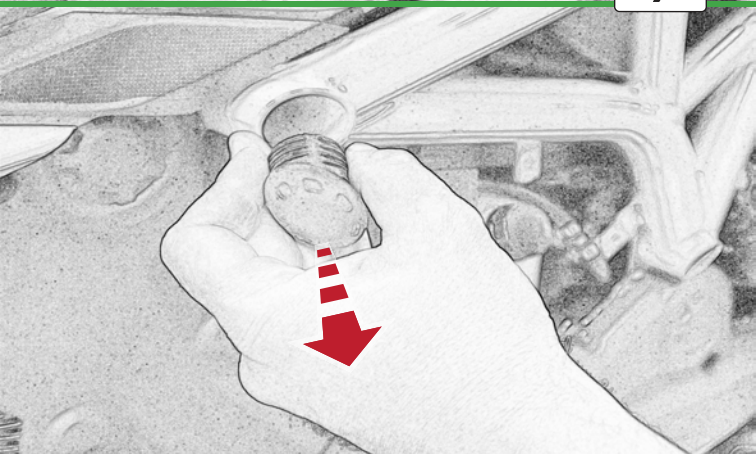

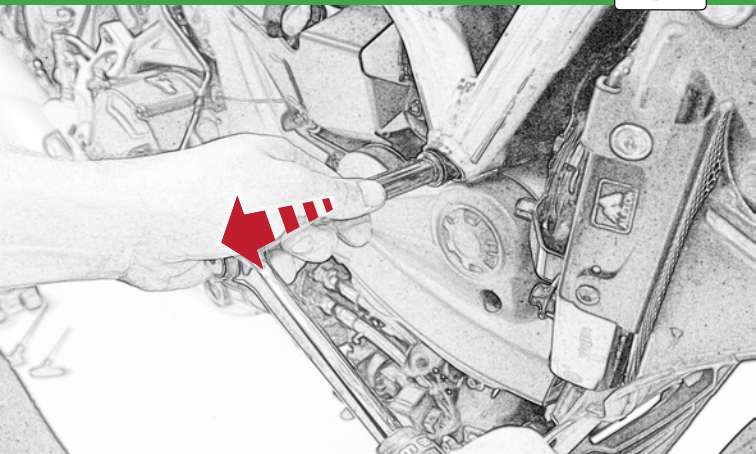

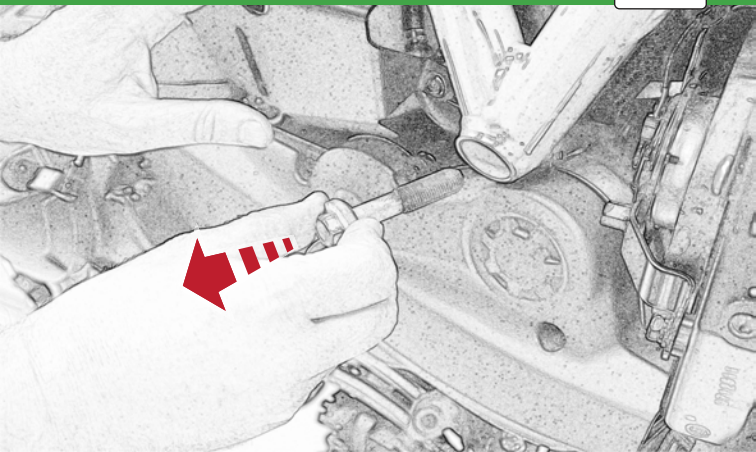

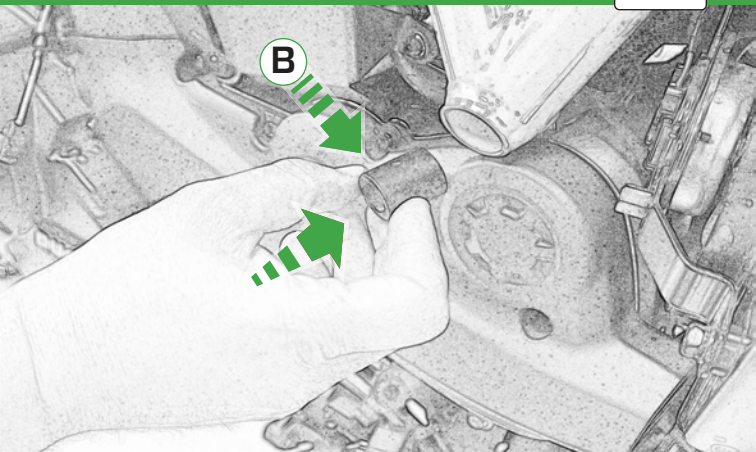

B



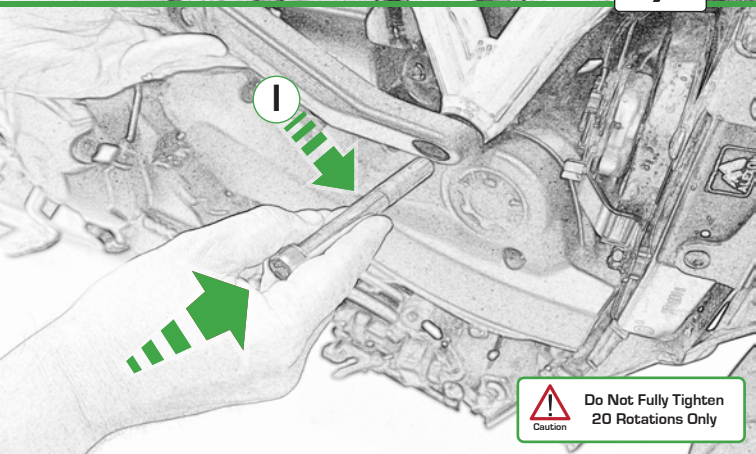

1



**Do Not Fully Tighten
20 Rotations Only**

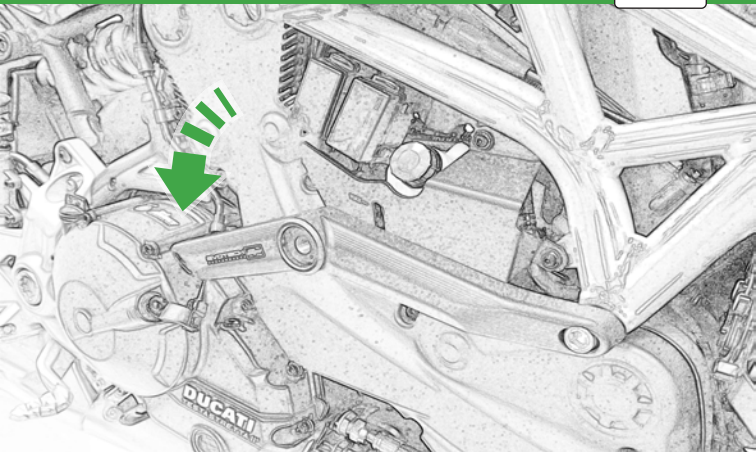

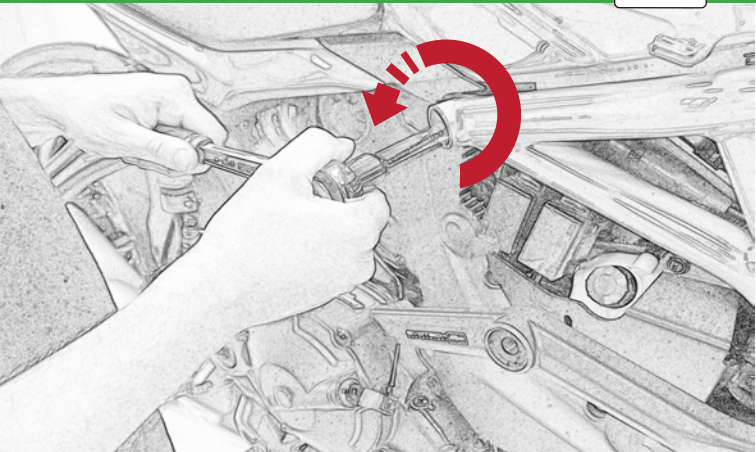

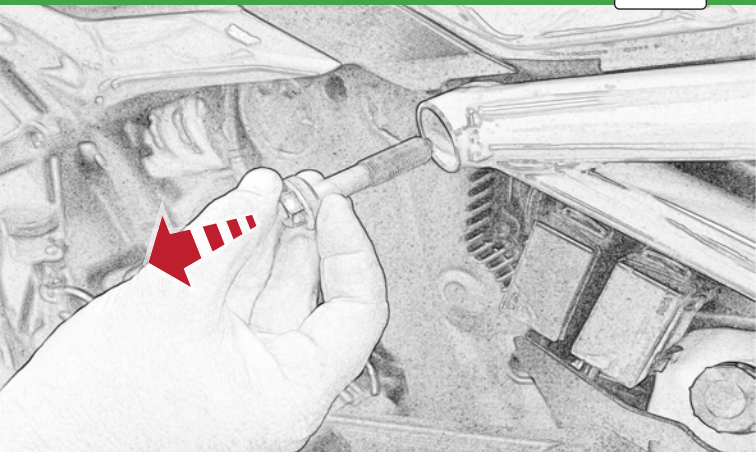

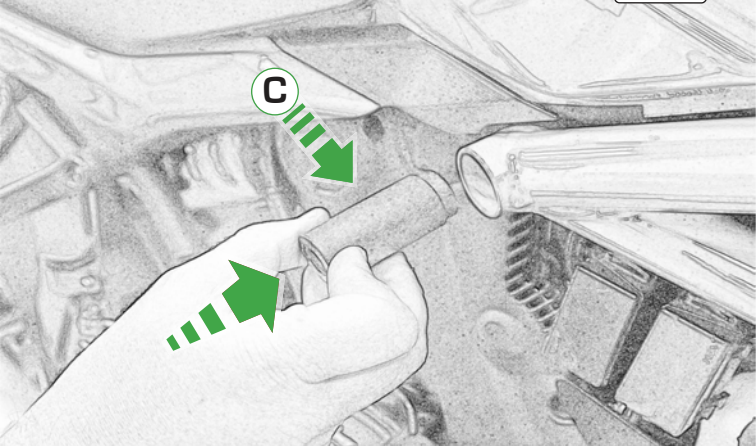

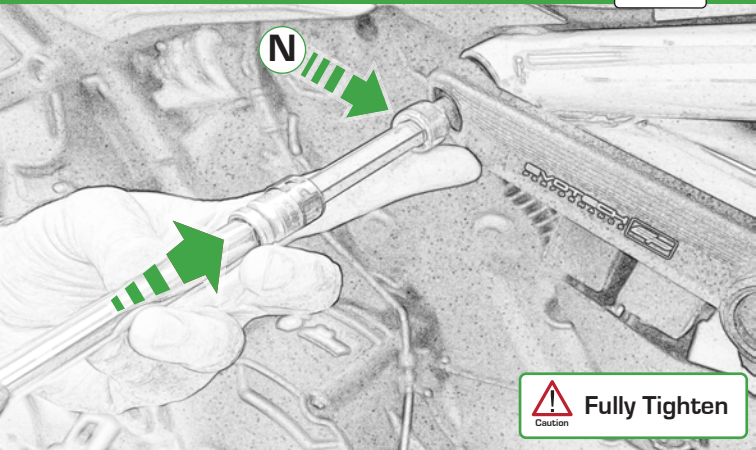

 **Fully Tighten**
Caution

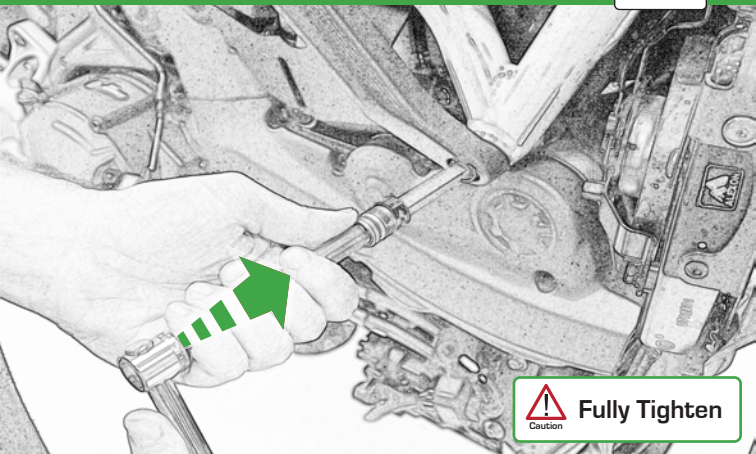

Caution

Fully Tighten

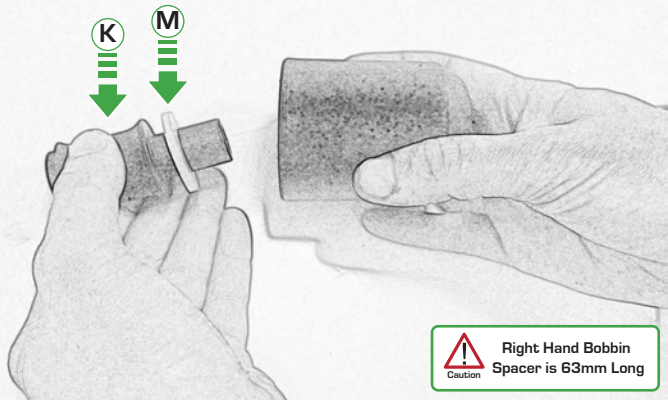

Caution

Right Hand Bobbin
Spacer is 63mm Long



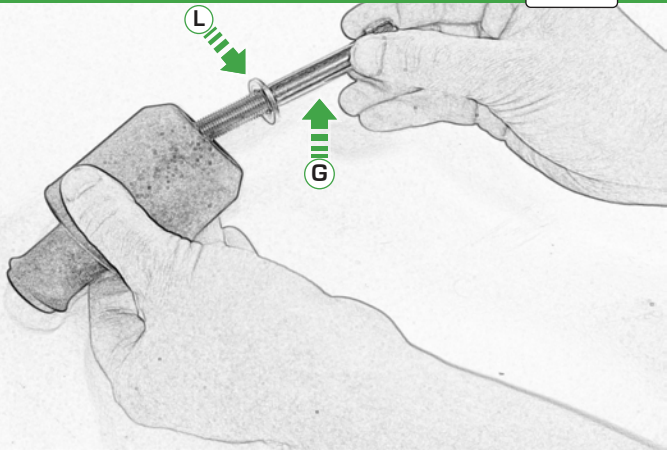

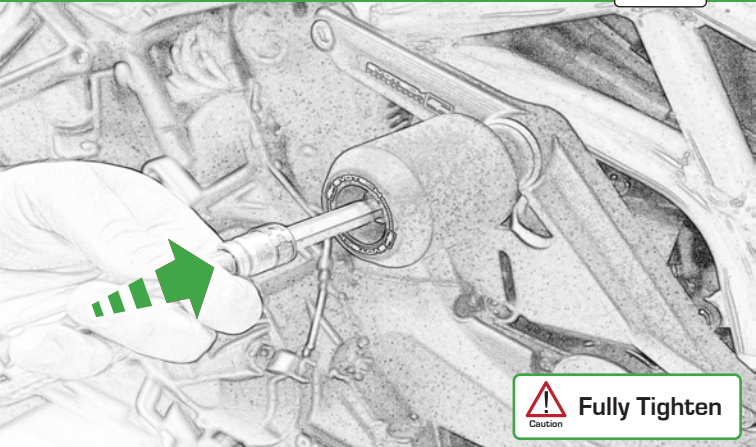

 **Fully Tighten**
Caution



Reverse Stages

15 - 1



ESSENTIAL CHECKS



It is recommended that periodic inspections are made to ensure that all bolts are tightened to the specified torque settings.

Should the bike be involved in an accident a thorough inspection should be made and any components that have taken an impact, no matter how small, be replaced



EVOTECH®
P E R F O R M A N C E

www.evotech-performance.com